

# COROMAL



# Windsor





# COROMAL Windsor ASSIST

*We've got you covered!*

- ✓ Complimentary 3 year cover
- ✓ 24/7 Roadside Assistance
- ✓ 130 locations Australia wide



Contact Coromal Windsor Assist

**1800 880 766**

## FUTURE TECK™

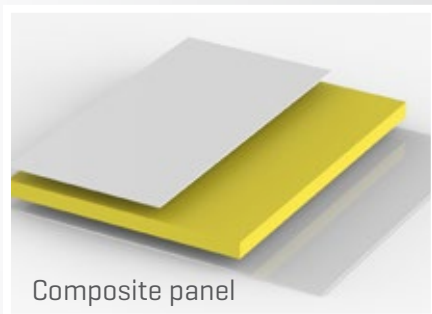

Composite panel

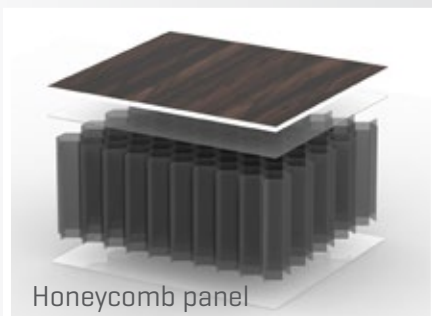

Honeycomb panel

Innovation and technology are imperative at Coromal Windsor. When developing our caravans, it is future performance and longevity that we work towards. Future Teck™ construction brings improved functionality and superior 'strength to weight ratio', making it the clear choice for our construction method.

Future Teck™ is made up of composite panel roof and wall construction with honeycomb panel flooring. Composite panel roof and wall systems are made from an exterior fibreglass, a foam insulation polyurethane core and fibreglass internal lining. The layers are chemically bonded into a single sheet, tailored to size using precision cutting technology.

Honeycomb panel flooring is made up of a vertical honeycomb core with internal and external skin components. It provides a high strength, lightweight material which does not absorb water and has excellent corrosion and fatigue resistance.

Future Teck™ construction provides a stronger exterior surface, less vulnerable to damage than traditional aluminium sheeting. The foam insulation core offers energy efficiency, keeping the space cooler in the summer and warmer in the winter, minimising of heating and cooling losses.

## LIFT TECK™

The revolutionary lifting system that has been engineered using 'worm drive' technology and designed for improved performance. Moving away from traditional methods which fail over time, the Lift Teck™ system provides reliable, easy performance when setting up or packing away.

## Exclusive to the SILHOUETTE





# ESY-TOW™ SUSPENSION

**COROMAL**  
*Australian Built Adventure*

**Windsor**  
*Travelling with you*

**WE'VE GOT YOUR  
SUSPENSION COVERED**  
*for all Australian conditions*

The ESY-Tow™ suspension provides a predictable and easy towing system using the leaf spring design. Shorter travel springs reduce bounce and eliminates sideways suspension movement for positive tracking. With no axle steer, each wheel is kept in constant linear alignment, offering functional ground clearance so you can travel between Australian roads, dirt tracks or extreme terrains with peace of mind.

**TOURER**



**SPORT**



**SPORT X**















**Windsor**  
*Travelling with you*

**COROMAL**  
*Australian Built Adventure*

**The Coromal and Windsor brands are Australia’s most recognised and well-regarded caravan manufacturers.**

Coromal have been building caravans for adventure since 1977. Originally designed to handle the harsh conditions of Western Australia’s north, these caravans and campers are loved throughout Australia. Built to last in the toughest Aussie conditions, all Coromal Caravans are constructed with high quality materials right here in Australia. With lightweight towing and extensive off road options

the Coromal will stand up to the toughest conditions that this great country can throw at it. After more than 40 years of building some of Australia’s best caravans and campers, Windsor continue to evolve with fresh, new models, outstanding offers and exciting promotions. All Windsor Caravans products come with a comprehensive express warranty.

<b>Coromal Range</b>		
	Princeton	8
	Element	12
	Appeal	20
	Pioneer XC	24
<b>Windsor Range</b>		
	Seka	32
	Silhouette	38
	Rapid	44
	Hybrid	48
<b>Swatches</b>		
Hard Furnishings		53
Soft Furnishings		55
Upholstery		55

Weights and specifications shown are indicative and are meant as a guide only. Weights may vary between builds and will change when adding options. Due to progressive product improvements all specifications are subject to change without notice. Images are not to scale and are only for illustration purposes.







# COROMAL PRINCETON

P691s | P710s | P735s

**The Coromal Princeton range offers luxurious space and comfort with contemporary styling. Packed with standard features, it offers all the ease to enjoy both long and short trips from home.**

Built in Western Australia with Future Teck™ construction, the Coromal Princeton features an electronic slide-out which adds up to 4.4m of extra space when extended. The additional living space allows for generous walkway areas around the club lounge dinette, queen size bed and bathroom/laundry.

The Esy-Tow™ Tourer suspension provides a predictable and easy towing system using the leaf spring design. The shorter travel springs reduce bounce and eliminates sideways suspension movement for positive tracking.

The A-frame style welded chassis with a DuraGal finish and 15" alloy mag wheels are all built and assembled in Western Australia. The A-frame holds two 9kg gas bottles, an outside mains water tap and quick-release jack legs.

The Princeton features a spacious kitchen with built in 190L 3-way powered fridge, stovetop with oven, microwave and 12v recessed range hood.

The feature stainless-steel bowl and drainer come with a contemporary vegetable mixer kitchen tap. Modern cabinetry has 25mm benchtops and full height splashbacks, and all drawers and cupboards have standard soft close functions and built in LED lighting for maximum storage options.

With a luxuriously appointed queen size bed including side tables and reading lights, the memory foam mattress allows for easy lifting to provide more storage options under the bed.

The upholstered club lounge dinette is great for watching the 32" or 48" TV or easily allows for a 6 place meal setting when the slide out is extended, perfect for entertaining.







With a luxuriously appointed queen size bed including side tables and reading lights, the memory foam mattress allows for easy lifting to provide more storage options under the bed.

The bathroom comes standard with a 4kg front loading washing machine and hot water system. The separate toilet and shower configuration with built in towel rails provides thoughtful storage and space solutions.

Large panoramic windows allow for plenty of natural light with built in fly screens and block-out blinds. The air conditioner with Future Teck™ construction provide ambient air temperatures with built in ceiling hatches and fans that address condensation.

The Coromal Princeton has an external slide-out kitchen, picnic table and entertainment system which allows for total enjoyment either inside or out. A built-in sound system has radio, CD and USB connectivity, providing sound through internal and external speakers.

The water gauge allows you to check the two 80L water tank levels before setting off, very useful when you need to carry drinking water on your trip. A built in reversing camera as standard.

Safety features include the stability ESC breaking system, smoke detector with fire extinguisher and non-slip recessed entry step with built in lighting and easy grip entry handles as standard on all models.

Safety features include the stability ESC breaking system, smoke detector with fire extinguisher and non-slip recessed entry step with built in lighting and easy grip entry handles as standard on all models.

## FLOOR PLANS

### Princeton P691s

Body Length (mm)	6,900
Overall Length (mm)	8,710
Overall Height - Standard (mm)	2,960
Interior Height (mm)	1,980
Overall Body Width (mm)	2,480
Tare Weight (kg)	2,670*
ATM Weight (kg)	3,170*



### Princeton P710s

Body Length (mm)	7,100
Overall Length (mm)	8,910
Overall Height - Standard (mm)	2,960
Interior Height (mm)	1,980
Overall Body Width (mm)	2,480
Tare Weight (kg)	2,750*
ATM Weight (kg)	3,250*

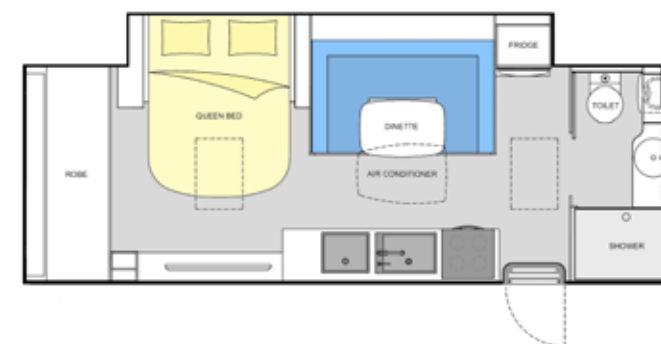

### Princeton P735s

Body Length (mm)	7,350
Overall Length (mm)	9,110
Overall Height - Standard (mm)	2,960
Interior Height (mm)	1,980
Overall Body Width (mm)	2,480
Tare Weight (kg)	2,830*
ATM Weight (kg)	3,330*

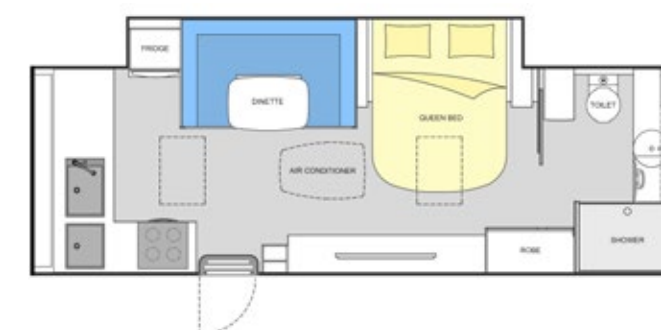

\*Note: Tare and ATM weights will vary when adding optional extras.





# COROMAL ELEMENT

E552s | E553s | E612s | E614s | E632s | E634s  
E636s | E661s | E662s | E663s | E696s

**The Coromal Element is a versatile range of caravans with layouts to suit all lifestyles. Experience memorable family holidays with the bunk options or spacious slide out features, the Coromal Element is designed to get you to your favourite holiday spots, any time of the year.**

The Esy-Tow™ Tourer suspension provides a predictable and easy towing system using the leaf spring design. The shorter travel springs reduce bounce and eliminates sideways suspension movement for positive tracking.

The Coromal Element has an A-frame style welded chassis with a DuraGal finish and 15" alloy mag wheels which is all built and assembled in Western Australia. The A-frame holds two 9kg gas bottles, an outside mains water tap and quick release jack legs.

The kitchen is packed with standard features such as a built in 190L 3-way powered fridge, stovetop with grill, microwave and 12v recessed range hood. The stainless-steel bowl and drainer come with a mixer kitchen tap. The modern cabinetry has 25mm

benchtops and full height splashbacks. All drawers and cupboards have standard soft close functions and built in LED lighting for maximum storage options.

The upholstered dinette provides a comfortable zone for meals or watching the 22" TV in the comfort of air conditioning.

The upholstered dinette provides a comfortable zone for meals or watching the 22" TV in the comfort of air conditioning. Large windows allow for plenty of natural light with built in fly screens and block-out blinds.

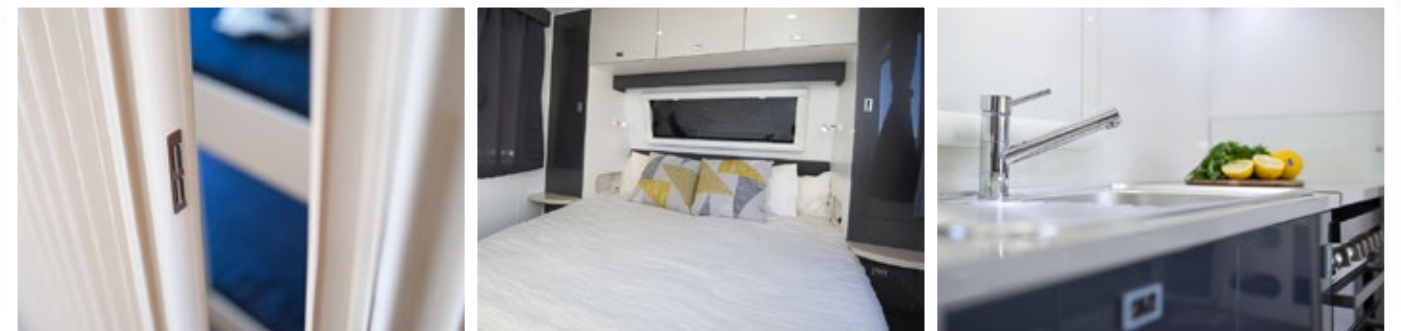





# FLOOR PLANS

## Element E552s

Body Length (mm)	5,500
Overall Length (mm)	7,320
Overall Height - Standard (mm)	2,860
Interior Height (mm)	1,980
Overall Body Width (mm)	2,480
Tare Weight (kg)	1,850*
ATM Weight (kg)	2,150*

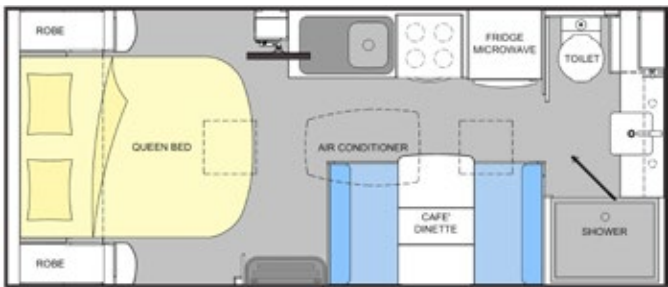

Single bed option available

## Element E553s

Body Length (mm)	5,500
Overall Length (mm)	7,320
Overall Height - Standard (mm)	2,860
Interior Height (mm)	1,980
Overall Body Width (mm)	2,480
Tare Weight (kg)	1,850*
ATM Weight (kg)	2,150*

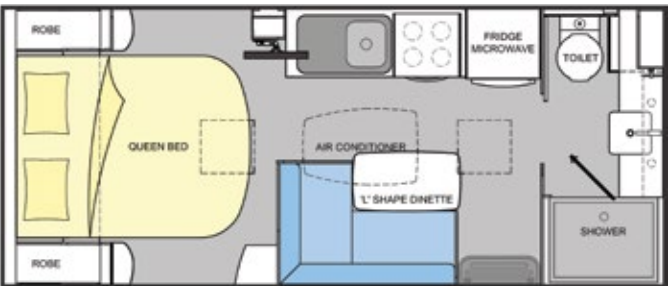

Single bed option available

## Element E612s

Body Length (mm)	6,153
Overall Length (mm)	7,670
Overall Height - Standard (mm)	2,860
Interior Height (mm)	1,980
Overall Body Width (mm)	2,480
Tare Weight (kg)	2,100*
ATM Weight (kg)	2,500*

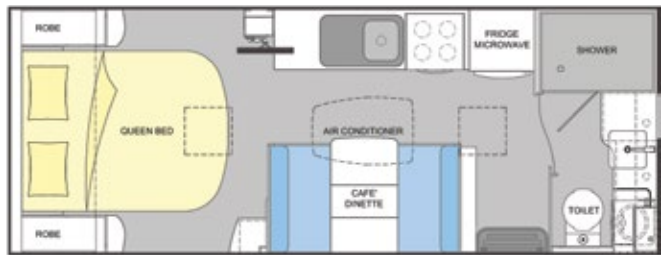

Single bed option available

Each of the bedroom configurations come with side tables, reading lights and memory foam mattress plus more storage options under the bed.

The bathroom comes with a 2.5kg top loading washing machine and hot water system. A toilet and shower configuration with built in towel rails offers thoughtful storage solutions.

The Coromal Element has a retractable awning and annex lights with external power outlet and TV point. A built-in sound system with radio, CD and USB connectivity provides sound through internal and external speakers.

The water gauge allows you to check the two 80L water tank levels before setting off, very useful when you need to carry drinking water on your trip. The Element range also has a built in reversing camera as standard.

Safety features include the stability ESC breaking system, smoke detector with fire extinguisher and non-slip ABS entry step with easy grip entry handles as standard on all models.

A built-in sound system with radio, CD and USB connectivity provides sound through internal and external speakers.

\*Note: Tare and ATM weights will vary when adding optional extras.





## Element E614s

Body Length (mm)	6,153
Overall Length (mm)	7,790
Overall Height - Standard (mm)	2,860
Interior Height (mm)	1,980
Overall Body Width (mm)	2,480
Tare Weight (kg)	2,100*
ATM Weight (kg)	2,500*

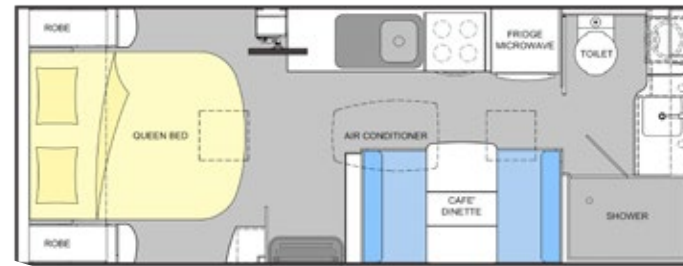

Single bed option available

## Element E632s

Body Length (mm)	6,300
Overall Length (mm)	8,100
Overall Height - Standard (mm)	2,860
Interior Height (mm)	1,980
Overall Body Width (mm)	2,480
Tare Weight (kg)	2,170*
ATM Weight (kg)	2,570*

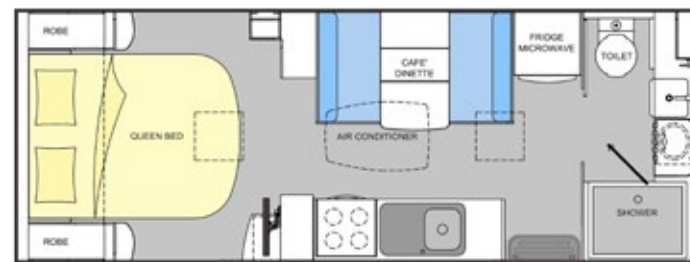

Single bed option available

## Element E634s

Body Length (mm)	6,300
Overall Length (mm)	8,100
Overall Height - Standard (mm)	2,860
Interior Height (mm)	1,980
Overall Body Width (mm)	2,480
Tare Weight (kg)	2,210*
ATM Weight (kg)	2,610*

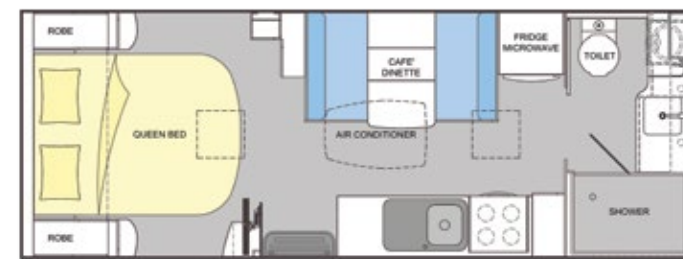

Single bed option available

## Element E636s

Body Length (mm)	6,300
Overall Length (mm)	8,100
Overall Height - Standard (mm)	2,860
Interior Height (mm)	1,980
Overall Body Width (mm)	2,480
Tare Weight (kg)	2,080*
ATM Weight (kg)	2,480*

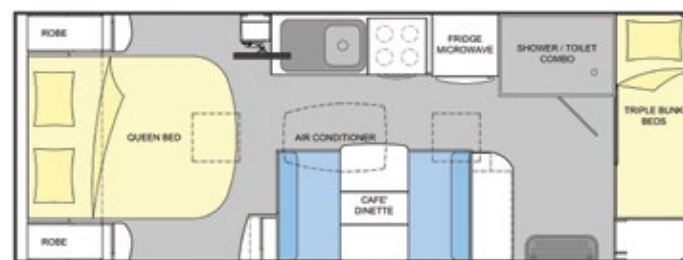

Single bed option available







## Element E661s

Body Length (mm)	6,600
Overall Length (mm)	8,410
Overall Height - Standard (mm)	2,860
Interior Height (mm)	1,980
Overall Body Width (mm)	2,480
Tare Weight (kg)	2,350*
ATM Weight (kg)	2,750*

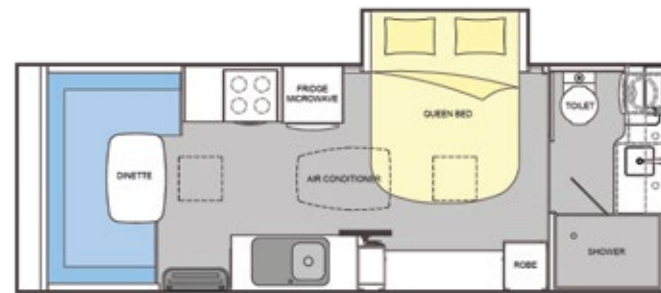

## Element E663s

Body Length (mm)	6,600
Overall Length (mm)	8,410
Overall Height - Standard (mm)	2,860
Interior Height (mm)	1,980
Overall Body Width (mm)	2,480
Tare Weight (kg)	2,260*
ATM Weight (kg)	2,660*

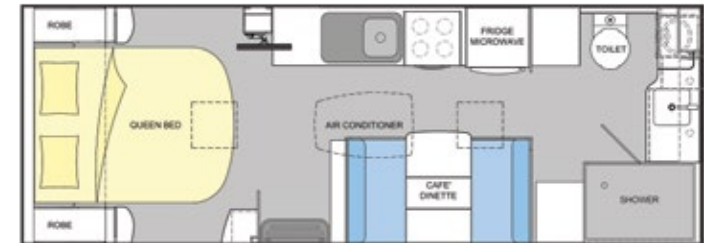

Single bed option available

## Element E662s

Body Length (mm)	6,600
Overall Length (mm)	8,120
Overall Height - Standard (mm)	2,860
Interior Height (mm)	1,980
Overall Body Width (mm)	2,480
Tare Weight (kg)	2,200*
ATM Weight (kg)	2,600*

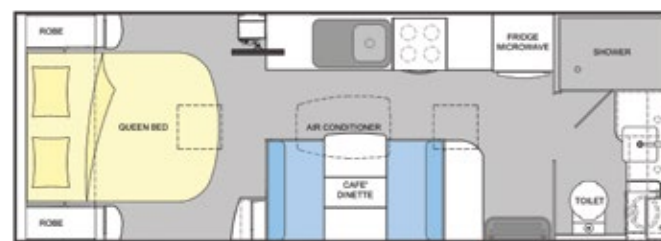

Single bed option available

## Element E696s

Body Length (mm)	6,900
Overall Length (mm)	8,710
Overall Height - Standard (mm)	2,860
Interior Height (mm)	1,980
Overall Body Width (mm)	2,480
Tare Weight (kg)	2,330*
ATM Weight (kg)	2,730*

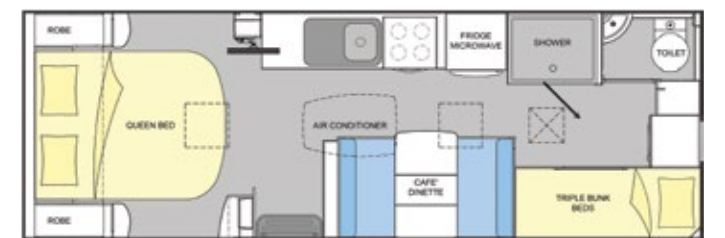

Single bed option available





# COROMAL APPEAL

AP554s | AP601s | AP647s

**The Coromal Appeal range allows you to explore the beauty of Australia in comfort and style. Packed full of features and great storage options, the Coromal Appeal makes it easy leave the hectic working week behind you, pull up in front of a beautiful view and relax.**

The Easy-Tow™ Tourer suspension provides a predictable and easy towing system using the leaf spring design. The shorter travel springs reduce bounce and eliminates sideways suspension movement for positive tracking.

The Coromal Appeal has an A-frame style welded chassis with a DuraGal finish and 15" alloy mag wheels, all built and assembled in Western Australia. The A-frame holds a 9kg gas bottle, an outside mains water tap and wind down jack legs.

The kitchen has a 150L 3-way powered fridge, stovetop with grill, microwave and 12v recessed range hood. The stainless-steel bowl and drainer come with a mixer kitchen tap. The modern cabinetry has 16mm benchtops and full height splashbacks. All drawers and cupboards have standard soft close functions and built in LED lighting for maximum storage options.

Each of the bedroom configurations come with side tables, reading lights and memory foam mattress plus more storage options under the bed.

The bathroom comes standard with a hot water system and a toilet and shower configuration with thoughtful storage solutions.

The Coromal Appeal has a retractable awning and annex lights with external power outlet and TV point. A built-in sound system with radio, CD and USB connectivity provides sound through internal and external speakers.

The kitchen has a 150L 3-way powered fridge, stovetop with grill, microwave and 12v recessed range hood.

The water gauge allows you to check the two 60L water tank levels before setting off, very useful when you need to carry drinking water on your trip.

Safety features include smoke detector with fire extinguisher and non-slip ABS step as standard on all models.







# FLOOR PLANS

## Appeal AP554s

Body Length (mm)	5,500
Overall Length (mm)	7,310
Overall Height - Standard (mm)	2,930
Interior Height (mm)	1,980
Overall Body Width (mm)	2,480
Tare Weight (kg)	1,610*
ATM Weight (kg)	1,910*

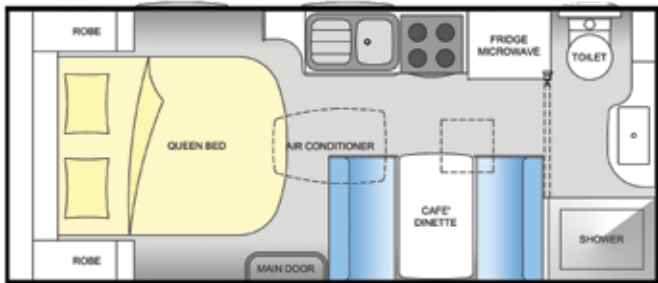

Alternative layout option: L shape dinette.

## Appeal AP601s

Body Length (mm)	6,000
Overall Length (mm)	7,830
Overall Height - Standard (mm)	2,930
Interior Height (mm)	1,980
Overall Body Width (mm)	2,480
Tare Weight (kg)	1,770*
ATM Weight (kg)	2,170*

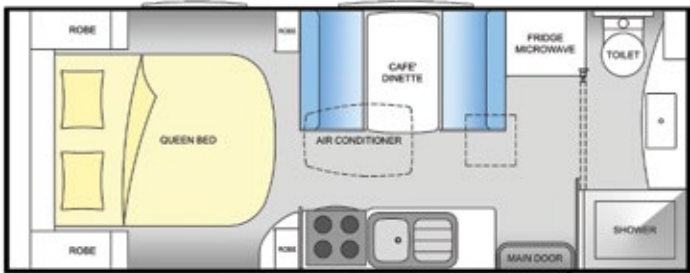

Alternative layout option: L shape dinette. Single bed option available.

## Appeal AP647s

Body Length (mm)	6,400
Overall Length (mm)	8,230
Overall Height - Standard (mm)	2,930
Interior Height (mm)	1,980
Overall Body Width (mm)	2,480
Tare Weight (kg)	1,820*
ATM Weight (kg)	2,220*

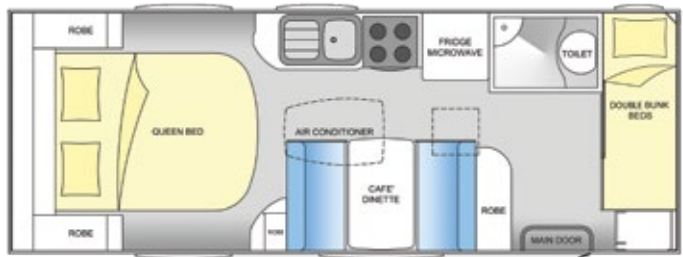

Alternative layout option: L shape dinette and triple bunk beds.

\*Note: Tare and ATM weights will vary when adding optional extras.





# COROMAL

## PIONEER XC

PXC552s | PXC553s | PXC612s | PXC632s  
PXC636s | PXC661s | PXC662s | PXC696s

**The Coromal Pioneer is designed for exploring the Australian Outback. Built in Western Australia, the Pioneer has a scrub bar, skid plates and front stone deflector ready for your next adventure. The solar panel, deep battery provision and grey water tanks allow for extended periods away from traditional caravan spots.**

The Esy-Tow™ Trailing Arm suspension provides a predictable and easy towing system using a coil and shock system which reduces bounce and eliminates sideways suspension movement for positive tracking.

The Coromal Pioneer has an A-frame style galvanised chassis, with a coupling swivel and 16" steel tyres which is all built and assembled in Western Australia. The A-frame holds two 9kg gas bottles as well as a large storage function for the provision of gas and jerry cans. The chassis mains tap is useful to wash down dirt from the day's adventure.

The kitchen is packed with standard features including a built in 190L 3-way powered fridge, stovetop with grill, microwave and 12v recessed range hood. The stainless-steel bowl and drainer come with a mixer kitchen tap. The Pioneer's modern cabinetry has 25mm benchtops and full height splashbacks; all drawers and cupboards have standard soft close functions and built in LED lighting for maximum storage options.

The upholstered dinette provides a comfortable zone for meals or watching the 22" TV in the comfort of air conditioning.

Large windows allow for plenty of natural lighting with built in fly screens, block-out blinds and convenient roof hatch.

Each of the bedroom configurations come with side tables, reading lights and memory foam mattress plus more storage options under the bed.

The bathroom comes with a 2.5kg top loading washing machine and hot water system. A toilet and shower configuration with built in towel rails offers thoughtful storage space solutions.

The Coromal Pioneer has a retractable awning and annex lights with external power outlet and TV point. Two solar panels provide adequate power to run all 12v appliances, including the built-in sound system with radio, CD and USB connectivity.

The water gauge allows you to check the two 80L water tank levels before setting off, very useful when you need to carry drinking water on your trip. A built in reversing camera as standard.

Safety features include the stability ESC breaking system, smoke detector with fire extinguisher and non-slip ABS entry step with easy grip entry handles as standard on all models.





# FLOOR PLANS

## Pioneer XC PXC552s

Body Length (mm)	5,500
Overall Length (mm)	7,565
Overall Height - Standard (mm)	3,050
Interior Height (mm)	1,980
Overall Body Width (mm)	2,480
Tare Weight (kg)	2,350*
ATM Weight (kg)	2,750*

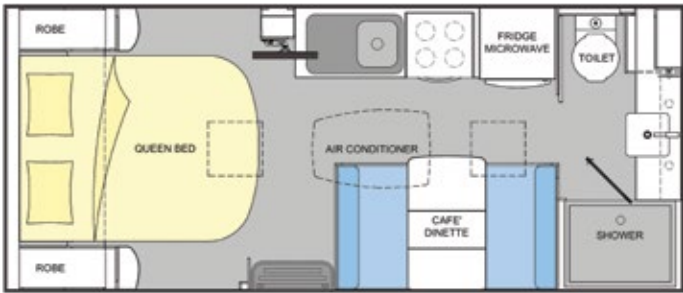

Alternative layout option: single bed option available

## Pioneer XC PXC553s

Body Length (mm)	5,500
Overall Length (mm)	7,565
Overall Height - Standard (mm)	3,050
Interior Height (mm)	1,980
Overall Body Width (mm)	2,480
Tare Weight (kg)	2,290*
ATM Weight (kg)	2,690*

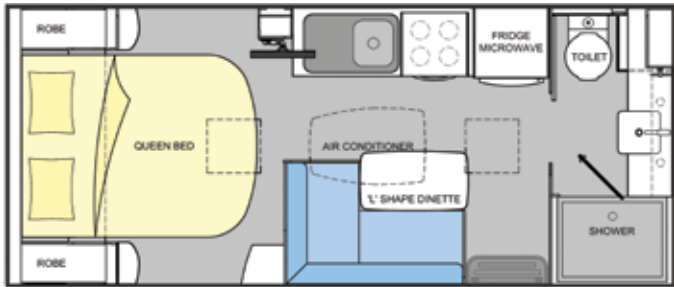

Alternative layout option: single bed option available

## Pioneer XC PXC612s

Body Length (mm)	6,150
Overall Length (mm)	8,250
Overall Height - Standard (mm)	3,050
Interior Height (mm)	1,980
Overall Body Width (mm)	2,480
Tare Weight (kg)	2,790*
ATM Weight (kg)	3,390*

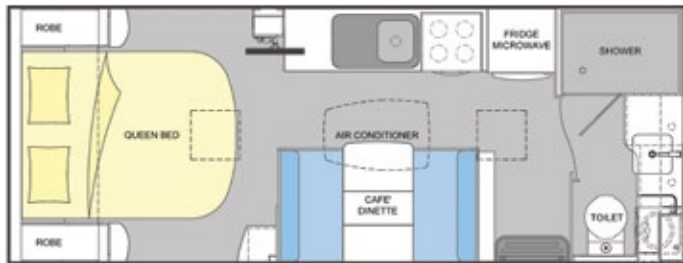

Alternative layout option: single bed option available







## Pioneer XC **PXC661s**

Body Length (mm)	6,600
Overall Length (mm)	8,760
Overall Height - Standard (mm)	3,050
Interior Height (mm)	1,980
Overall Body Width (mm)	2,480
Tare Weight (kg)	2,960*
ATM Weight (kg)	3,460*

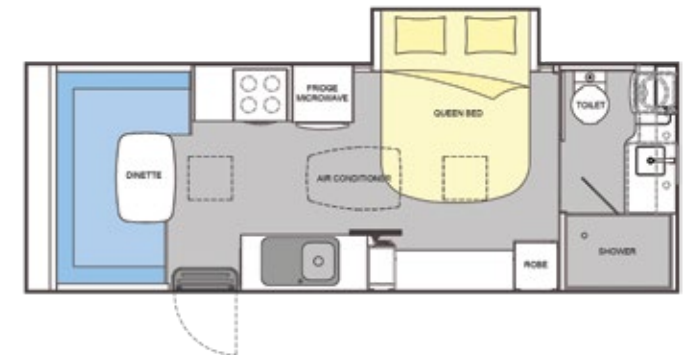

Alternative layout option: single bed option available

## Pioneer XC **PXC632s**

Body Length (mm)	6,300
Overall Length (mm)	8,425
Overall Height - Standard (mm)	3,050
Interior Height (mm)	1,980
Overall Body Width (mm)	2,480
Tare Weight (kg)	2,770*
ATM Weight (kg)	3,370*

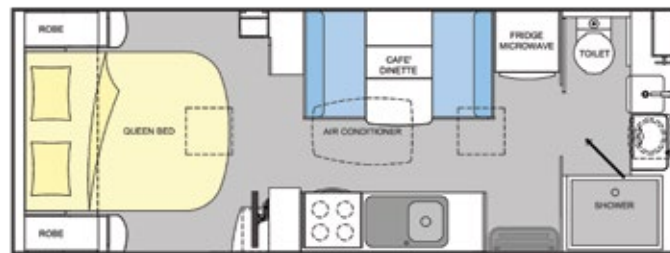

Alternative layout option: single bed option available

## Pioneer XC **PXC662s**

Body Length (mm)	6,600
Overall Length (mm)	8,760
Overall Height - Standard (mm)	3,050
Interior Height (mm)	1,980
Overall Body Width (mm)	2,480
Tare Weight (kg)	2,860*
ATM Weight (kg)	3,360*

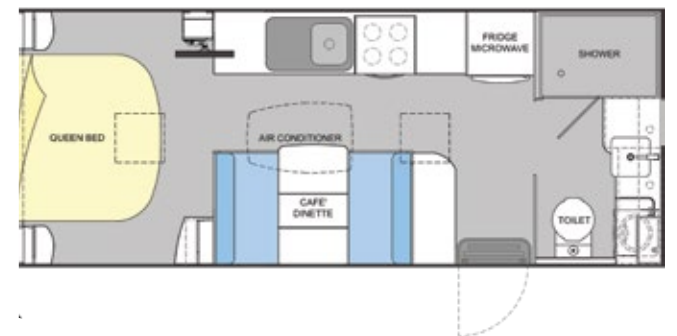

## Pioneer XC **PXC636s**

Body Length (mm)	6,300
Overall Length (mm)	8,425
Overall Height - Standard (mm)	3,050
Interior Height (mm)	1,980
Overall Body Width (mm)	2,480
Tare Weight (kg)	2,780*
ATM Weight (kg)	3,380*

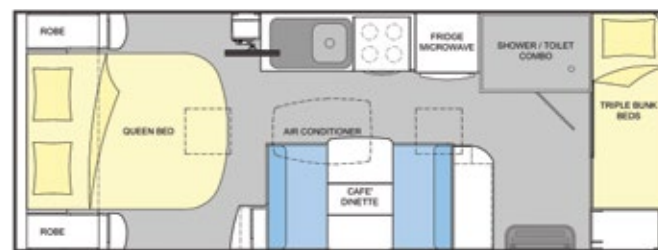

Alternative layout option: single bed option available

## Pioneer XC **PXC696s**

Body Length (mm)	6,900
Overall Length (mm)	9,010
Overall Height - Standard (mm)	3,050
Interior Height (mm)	1,980
Overall Body Width (mm)	2,480
Tare Weight (kg)	2,950*
ATM Weight (kg)	3,450*

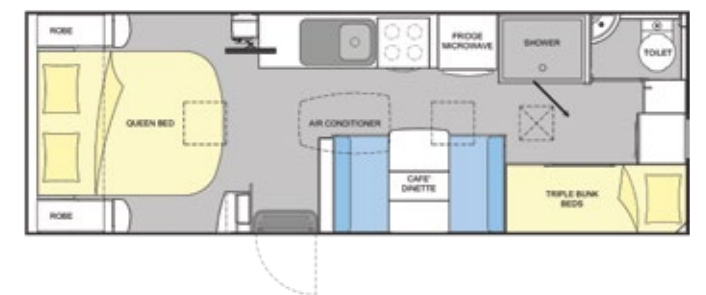







# Windsor SEKA

SK/SKL521 | SK/SKL552s | SK554

SK/SKL567s | SK569 | SK611s

**The Windsor Seka is a range of pop top caravans with the family in mind. Designed for storage in garages and carports when not in use, the ultra-lowline design allows for the antenna to sit under 2.1 metres when stored, but erects to full caravan height when extended.**

Built in Western Australia with Future Teck™ construction, the low tow height is great for storage at home and greater fuel efficiency when on the move.

The Esy-Tow™ Tourer suspension provides a predictable and easy towing system using the leaf spring design. The shorter travel springs reduce bounce and eliminates sideways suspension movement for positive tracking.

The Windsor Seka has an A-frame style welded chassis with a DuraGal finish and 15" alloy wheels which is all built and assembled in Western Australia. The A-frame holds two 9kg gas bottles, an outside mains water tap and quick release jack legs.

A full kitchen with built in 90L 3-way powered fridge, stovetop with grill, microwave and 12v range hood. The stainless-steel bowl and drainer come with a swivel mixer kitchen tap. Flush gloss

cabinetry with soft close drawers, and built in LED lighting to keep everything in place when in use or on the move. The canvas windows allow for airflow with built in fly screens to keep out the bugs.

**Flush gloss cabinetry with soft close drawers and built in LED lighting to keep everything in place when in use or on the move.**

All models come with an easy to lift bed with underneath storage, memory foam mattresses, block out blinds and built in air conditioning for comfort. The Windsor Seka comes in layouts that include or exclude ensuite facilities.







The Windsor Seka has a retractable awning and annex lights with external power outlet and TV point. A built-in sound system with radio, CD and USB connectivity provides sound through internal and external speakers.

The water gauge allows you to check the 80L water tank levels before setting off, very useful when you need to carry drinking water on your trip.

Safety features include smoke detector with fire extinguisher and non-slip step entry as standard on all models

Coromal Windsor have been building caravans for over 40 years since 1977 in Australia, building a reputation craftsmanship, safety and excellence

The Windsor Seka has a retractable awning and annex lights with external power outlet and TV point.

## FLOOR PLANS

### Seka SK521

Body Length (mm)	5,240
Overall Length (mm)	7,050
Overall Height, Roof Up (mm)	2,840
Overall Height, Roof Down (mm)	2,400
Overall Body Width (mm)	2,540
Tare Weight (kg)	1,550*
ATM Weight (kg)	1,850*



Alternative layout option: 2 x single beds

### Seka SK552s

Body Length (mm)	5,545
Overall Length (mm)	7,355
Overall Height, Roof Up (mm)	2,840
Overall Height, Roof Down (mm)	2,400
Overall Body Width (mm)	2,540
Tare Weight (kg)	1,630*
ATM Weight (kg)	1,930*



Alternative layout options:  
2 x single beds and/or L shape dinette

### Seka SK554

Body Length (mm)	5,545
Overall Length (mm)	7,355
Overall Height, Roof Up (mm)	2,840
Overall Height, Roof Down (mm)	2,400
Overall Body Width (mm)	2,540
Tare Weight (kg)	1,560*
ATM Weight (kg)	1,860*



Alternative layout options:  
2 x single beds and/or L shape dinette

\*Note: Tare and ATM weights will vary when adding optional extras.





# FLOOR PLANS

Seka SK567s

Body Length (mm)	5,670
Overall Length (mm)	7,455
Overall Height, Roof Up (mm)	2,840
Overall Height, Roof Down (mm)	2,400
Overall Body Width (mm)	2,540
Tare Weight - SK (kg)	1,830*
ATM Weight - SK (kg)	2,230*

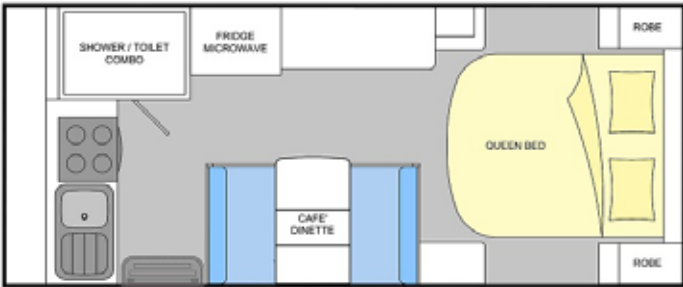

Alternative layout options:  
2 × single beds and/or L shape dinette

Seka SK569

Body Length (mm)	5,670
Overall Length (mm)	7,455
Overall Height, Roof Up (mm)	2,840
Overall Height, Roof Down (mm)	2,400
Overall Body Width (mm)	2,540
Tare Weight (kg)	1,740*
ATM Weight (kg)	2,140*



Alternative layout option: 2 × single beds

Seka SK611s

Body Length (mm)	6,170
Overall Length (mm)	7,950
Overall Height, Roof Up (mm)	2,840
Overall Height, Roof Down (mm)	2,400
Overall Body Width (mm)	2,540
Tare Weight (kg)	1,900*
ATM Weight (kg)	2,300*

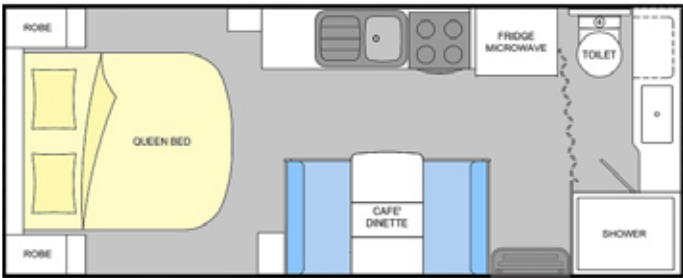

Alternative layout options:  
2 × single beds and/or L shape dinette

# FLOOR PLANS

Seka SKL521

Body Length (mm)	5,240
Overall Length (mm)	7,000
Overall Height, Roof Up (mm)	2,710
Overall Height, Roof Down (mm)	2,125
Overall Body Width (mm)	2,540
Tare Weight - SKL (kg)	1,470*
ATM Weight - SKL (kg)	1,820*



Alternative layout option: 2 × single beds

Seka SKL552s

Body Length (mm)	5,545
Overall Length (mm)	7,355
Overall Height, Roof Up (mm)	2,710
Overall Height, Roof Down (mm)	2,125
Overall Body Width (mm)	2,540
Tare Weight (kg)	1,610*
ATM Weight (kg)	1,960*

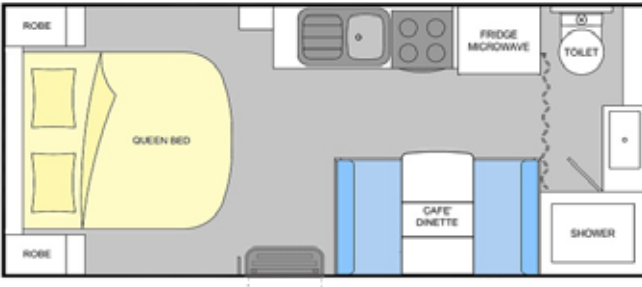

Alternative layout options:  
2 × single beds and/or L shape dinette

Seka SKL567s

Body Length (mm)	5,670
Overall Length (mm)	7,455
Overall Height, Roof Up (mm)	2,710
Overall Height, Roof Down (mm)	2,125
Overall Body Width (mm)	2,540
Tare Weight (kg)	1,720*
ATM Weight (kg)	2,120*

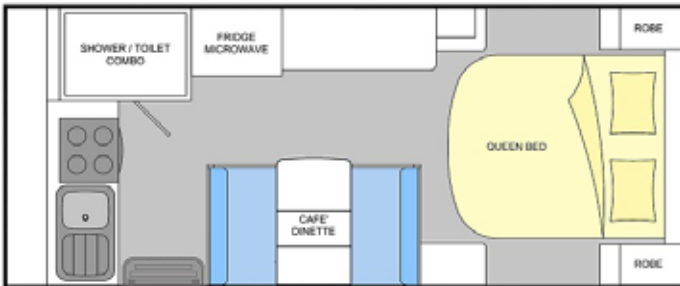

Alternative layout options:  
2 × single beds and/or L shape dinette

\*Note: Tare and ATM weights will vary when adding optional extras.

\*Note: Tare and ATM weights will vary when adding optional extras.



# Windsor SILHOUETTE

S400 XC/X4 | S401 XC/X4 | S421 XC/X4 | S450 XC/X4

**The Windsor Silhouette is a range of campers built for all terrain adventures. From iconic stock routes to stunning national parks and everything in between, the Windsor Silhouette gives you the freedom to explore.**

Built in Western Australia with Future Teck™ construction, the low tow height is great for storage at home and greater fuel efficiency when on the move.

Lift Teck™ offers cable-free technology that moves away from unreliable lifting systems. Lift Teck™ provides a reliable way to set up and pack away your camper when your focus is getting back on the road to your next destination.

The Ezy-Tow™ Sport X and Trailing Arm suspension provides a predictable and easy towing system using a coil and shock system which reduces bounce and eliminates sideways suspension movement for positive tracking.

The Windsor Silhouette has an A-frame style galvanised chassis, with a coupling swivel and 16" alloy or mud terrain wheels which is all built and assembled in Western Australia. The A-frame holds two 9kg gas bottles as well as a large toolbox and a mains tap that's useful to wash down dirt from the days' adventure.

Full kitchen with built in 90L 3-way powered fridge, stovetop, microwave and stainless-steel sink. There

is plenty of bench space when in use and lower cupboards to keep everything in place when you are on the move.

All models come with a memory foam mattress for each bed and bedroom privacy curtains. Collapsible wardrobes provide ample storage when in use. The canvas windows have fly screens and curtains as standard which allows maximum airflow.

The Windsor Silhouette has a box awning and annex lights with external power outlet and TV point. A built-in sound system with radio, CD and USB connectivity provides sound through internal and external speakers.

The water gauge allows you to check the three 43l water tank levels before setting off, very useful when you need to carry drinking water on your trip. The external hand-held shower is standard across all models.

Safety features include smoke detector with fire extinguisher and non slip step entry as standard on all models.







# FLOOR PLANS

Silhouette **S400XC**

Body Length (mm)	3,400
Overall Length (mm)	5,430
Overall Height, Roof Up (mm)	3,176
Overall Height, Roof Down (mm)	2,220
Overall Body Width (mm)	2,190
Tare Weight (kg)	1,680*
ATM Weight (kg)	2,080*

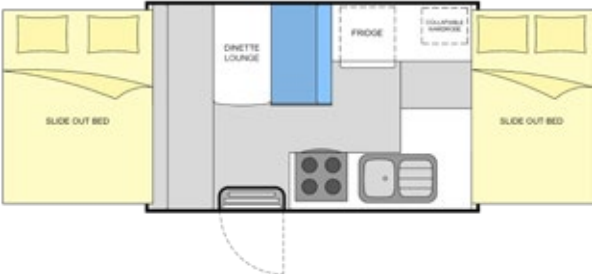

Silhouette **S401XC**

Body Length (mm)	3,400
Overall Length (mm)	5,430
Overall Height, Roof Up (mm)	3,176
Overall Height, Roof Down (mm)	2,220
Overall Body Width (mm)	2,190
Tare Weight (kg)	1,770*
ATM Weight (kg)	2,170*



Silhouette **S421XC**

Body Length (mm)	3,600
Overall Length (mm)	5,630
Overall Height, Roof Up (mm)	3,176
Overall Height, Roof Down (mm)	2,220
Overall Body Width (mm)	2,210
Tare Weight (kg)	1,780*
ATM Weight (kg)	2,180*

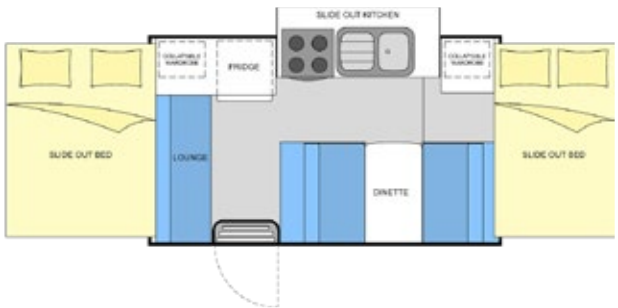

Silhouette **S450XC**

Body Length (mm)	3,900
Overall Length (mm)	5,920
Overall Height, Roof Up (mm)	3,176
Overall Height, Roof Down (mm)	2,220
Overall Body Width (mm)	2,210
Tare Weight (kg)	1,830*
ATM Weight (kg)	2,230*

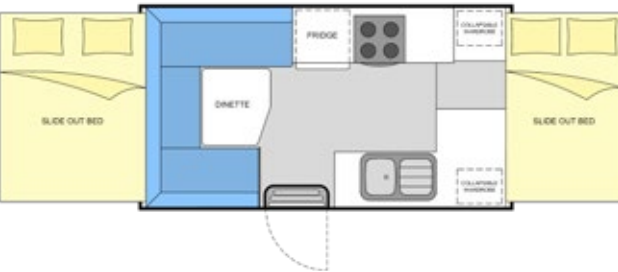





### Silhouette S400X4

Body Length (mm)	3,400
Overall Length (mm)	5,430
Overall Height, Roof Up (mm)	3,052
Overall Height, Roof Down (mm)	2,095
Overall Body Width (mm)	2,190
Tare Weight (kg)	1,780*
ATM Weight (kg)	2,180*

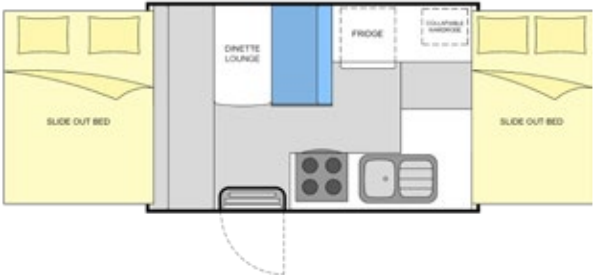

### Silhouette S421X4

Body Length (mm)	3,600
Overall Length (mm)	5,630
Overall Height, Roof Up (mm)	3,052
Overall Height, Roof Down (mm)	2,095
Overall Body Width (mm)	2,210
Tare Weight (kg)	1,870*
ATM Weight (kg)	2,270*

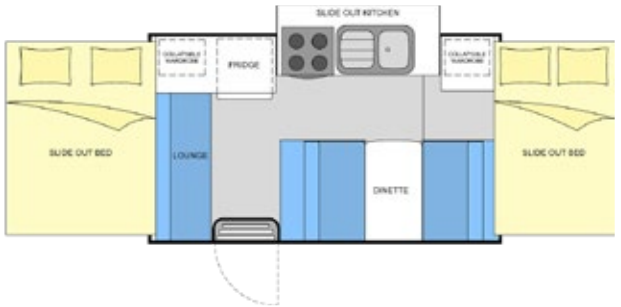

### Silhouette S401X4

Body Length (mm)	3,400
Overall Length (mm)	5,430
Overall Height, Roof Up (mm)	3,052
Overall Height, Roof Down (mm)	2,095
Overall Body Width (mm)	2,190
Tare Weight (kg)	1,860*
ATM Weight (kg)	2,260*

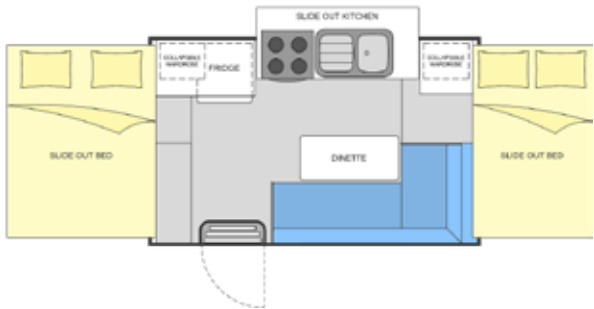

### Silhouette S450X4

Body Length (mm)	3,900
Overall Length (mm)	5,920
Overall Height, Roof Up (mm)	3,052
Overall Height, Roof Down (mm)	2,095
Overall Body Width (mm)	2,210
Tare Weight (kg)	1,930*
ATM Weight (kg)	2,330*

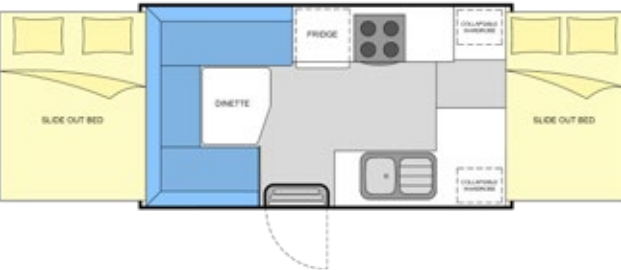



# Windsor RAPID

RAL456 | RAL501s | RAL549 | RAL563s

**The Windsor Rapid is a range of pop top caravans designed with the family in mind. As the name suggests, the set-up is quick and when packed away it can be stored easily in garages or carports.**

Built in Western Australia with Future Teck™ construction, the low tow height is great for storage at home and greater fuel efficiency when on the move.

The Esy-Tow™ Tourer suspension provides a predictable and easy towing system using the leaf spring design. The shorter travel springs reduce bounce and eliminates sideways suspension movement for positive tracking.

The Windsor Rapid has an A-frame style welded chassis with a DuraGal finish and 16" alloy wheels which is all built and assembled in Western Australia. The A-frame holds two 4kg gas bottles, an outside mains water tap and quick release jack legs.

A full kitchen with either a 90L or 150L built in 3-way powered fridge, stovetop with grill, microwave and 12v range hood. The stainless-steel bowl and drainer come with a swivel mixer kitchen tap. Flush gloss cabinetry with soft close drawers, and built in LED lighting to keep everything in place when in use or on the move.

Easy assembly bed ends with privacy bed curtains, block out window blinds and built in air conditioning for comfort. The Windsor Rapid comes in layouts that include or exclude ensuite facilities.

The Windsor Rapid has a retractable awning and annex lights with external power outlet and TV point. A built-in sound system with radio, CD and USB connectivity provides sound through internal and external speakers.

The water gauge allows you to check the 80L water tank levels before setting off, very useful when you need to carry drinking water on your trip.

Safety features include smoke detector with fire extinguisher and non-slip step entry as standard on all models.





# FLOOR PLANS

Rapid **RAL456**

Body Length (mm)	4,510
Overall Length (mm)	6,160
Overall Height, Roof Up (mm)	2,750
Overall Height, Roof Down (mm)	2,160
Overall Body Width (mm)	2,480
Tare Weight (kg)	1,400*
ATM Weight (kg)	1,800*

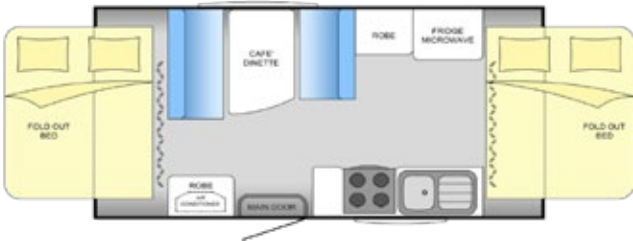

Rapid **RAL501s**

Body Length (mm)	5,010
Overall Length (mm)	6,660
Overall Height, Roof Up (mm)	2,750
Overall Height, Roof Down (mm)	2,150
Overall Body Width (mm)	2,480
Tare Weight (kg)	1,590*
ATM Weight (kg)	1,990*



Rapid **RAL549**

Body Length (mm)	5,420
Overall Length (mm)	7,060
Overall Height, Roof Up (mm)	2,750
Overall Height, Roof Down (mm)	2,150
Overall Body Width (mm)	2,480
Tare Weight (kg)	1,650*
ATM Weight (kg)	2,050*

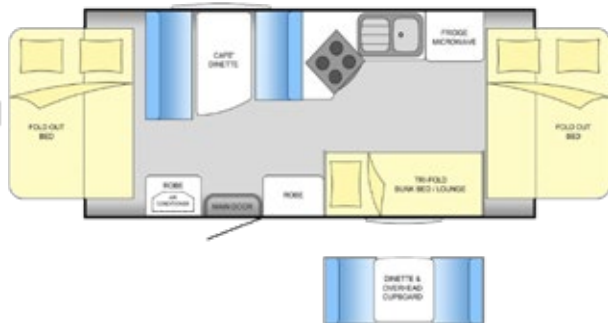

Rapid **RAL563s**

Body Length (mm)	5,620
Overall Length (mm)	7,260
Overall Height, Roof Up (mm)	2,750
Overall Height, Roof Down (mm)	2,150
Overall Body Width (mm)	2,480
Tare Weight (kg)	1,800*
ATM Weight (kg)	2,200*

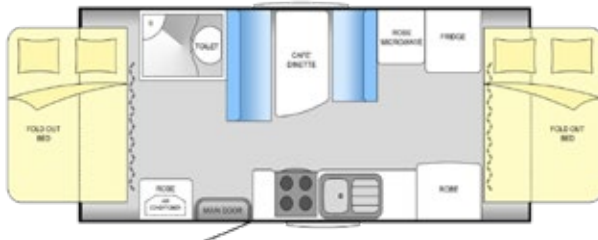



# Windsor HYBRID

H390 | H393XC

**The Windsor Hybrid is a range of compact multipurpose campers. The light weight design offers the outback experience that you can tow without the heavy weight vehicle.**

Built in Western Australia with Future Teck™ construction, the low tow height is great for storage at home and greater fuel efficiency when on the move.

The Windsor Hybrid provides for a Tourer, Sport or Sport X Esy-Tow™ independent suspension, allows provides a predictable and easy towing system. The shorter travel springs reduce bounce and eliminates sideways suspension movement for positive tracking.

The Windsor Hybrid has an A-frame style galvanised chassis, with a coupling swivel and 16" wheels which are all built and assembled in Western Australia. The A-frame holds a 9kg gas bottle, a large toolbox with quick release jack legs.

The slide out external kitchen has a built-in barbecue and 50L portable fridge freezer comes as standard on all models

The Windsor Hybrid comes with a full-size queen bed plus additional occasional bed space. The Hybrid has a batwing awning and flexible solar power panels to provide plenty of power options to run from 12v or 240v power source. A built-in sound system with radio, CD and USB connectivity provides sound through internal and external speakers.

The water gauge allows you to check the 60L water tank levels before setting off, very useful when you need to carry drinking water on your trip. The external hand-held shower is standard across all models.

Safety features include smoke detector with fire extinguisher and non-slip step entry as standard on all models.







## FLOOR PLANS

### Hybrid H390

Body Length (mm)	3,909
Overall Length (mm)	5,430
Overall Height, Roof Up (mm)	2,800
Overall Height, Roof Down (mm)	2,250
Overall Body Width (mm)	2,170
Tare Weight (kg)	1,180*
ATM Weight (kg)	1,580*



RTV and XC model also available

### Hybrid H393XC

Body Length (mm)	3,700
Overall Length (mm)	5,840
Overall Height, Roof Up (mm)	3,000
Overall Height, Roof Down (mm)	2,450
Overall Body Width (mm)	2,170
Tare Weight (kg)	1,670*
ATM Weight (kg)	2,270*

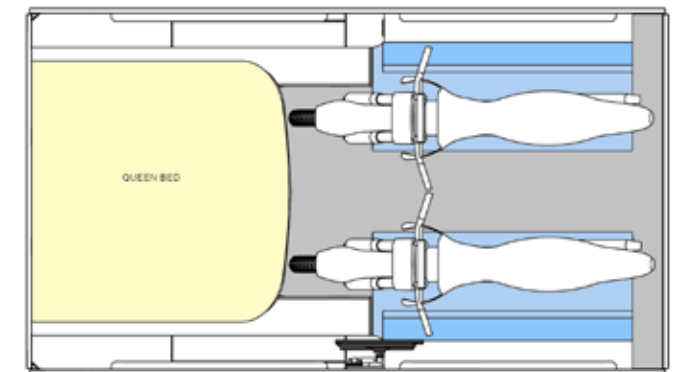

RTV model also available

\*Note: Tare and ATM weights will vary when adding optional extras.





## HARD FURNISHINGS

### Flooring

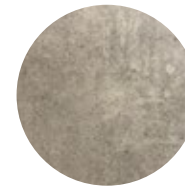

Alferro\*



Alure\*

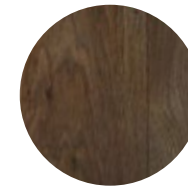

Aspin Black\*



Brown Concrete\*

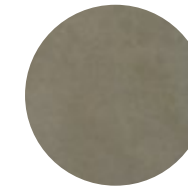

Grey Concrete\*

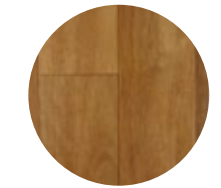

Spotted Gum\*

### Splashbacks

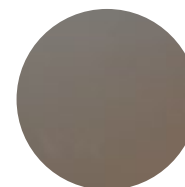

Cappuccino\*



Carrara Ice\*



Dusk Grey\*

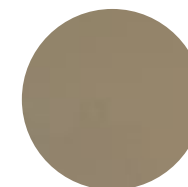

Latte\*



Rosano Sands\*



Snow White\*

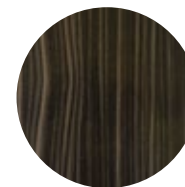

Zebra\*

### Laminates

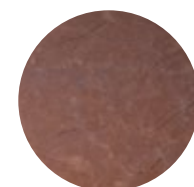

Evening Tigris\*



Kalahari\*



Smokey Topaz\*

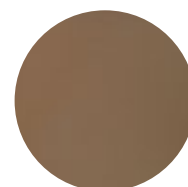

Vega Moonstone\*



Vega Mega White\*



Vega Felt\*



# HARD FURNISHINGS CONT.

## Cabinet Doors Standard Selection



## Cabinet Doors Premium Selection

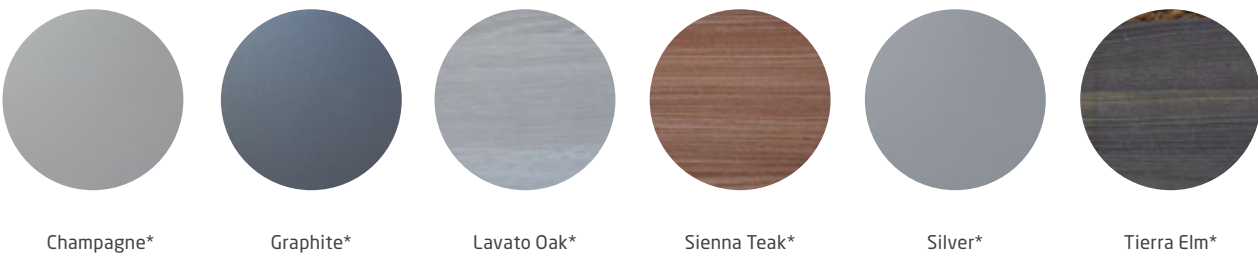

## Furniture



# SOFT FURNISHINGS

## Curtains



## Bedspread



# UPHOLSTERY

## Fabric

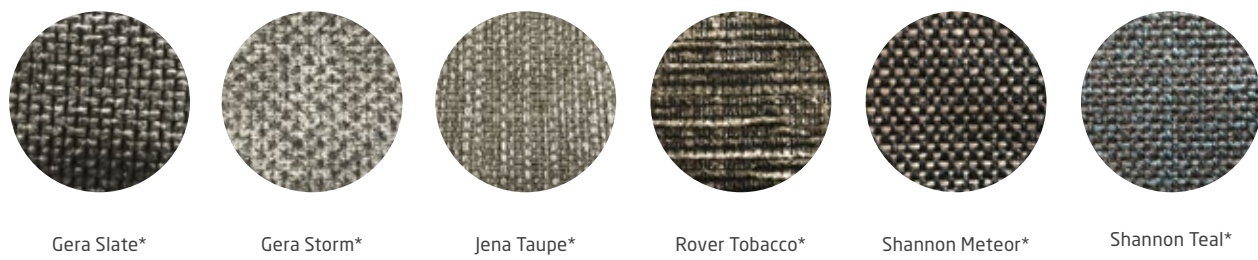

## Leather & Leatherette

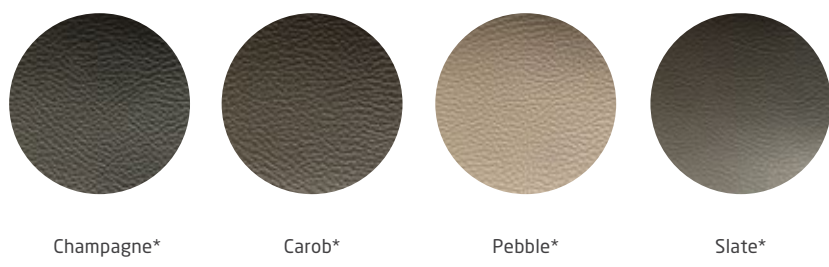



**COROMALWINDSOR.COM.AU**  
**1800 COROMAL | 18001 WINDSOR**

